

WIT Library Building, Waterford Ireland



Summary:

- IES <VE> model used to maximise the use of thermal mass/inertia, high insulation levels, natural light and ventilation systems, renewable energy systems and ambient energy.
- Sustainable Building of the Year 2000



- Underground ducting for free cooling
- Displacement ventilation
- Exposed thermal mass
- Night cooling
- No mechanical cooling
- Large north facing atrium
- Façade design including effective shading systems

The building has been in use since 2000

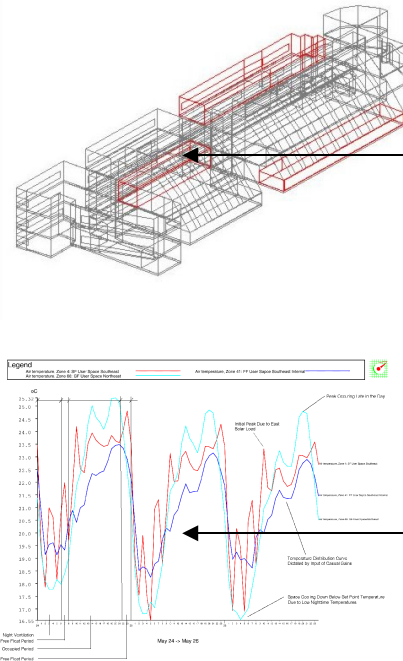

Influence of thermal mass and night cooling

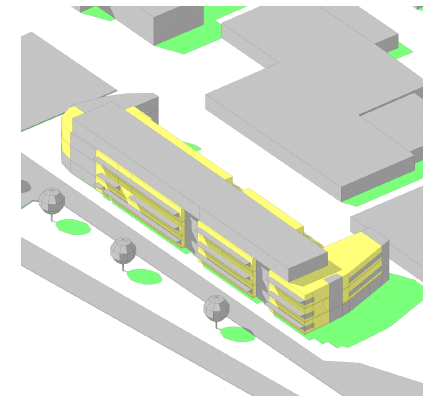

IES <VE> model of the building

In conjunction with:

A & D Wejchert architects

For and on behalf of:

