



IESVE
Trial Support
Material

www.iesve.com

ApacheSim:
Input Data Visualisation

Input Data Visualisation

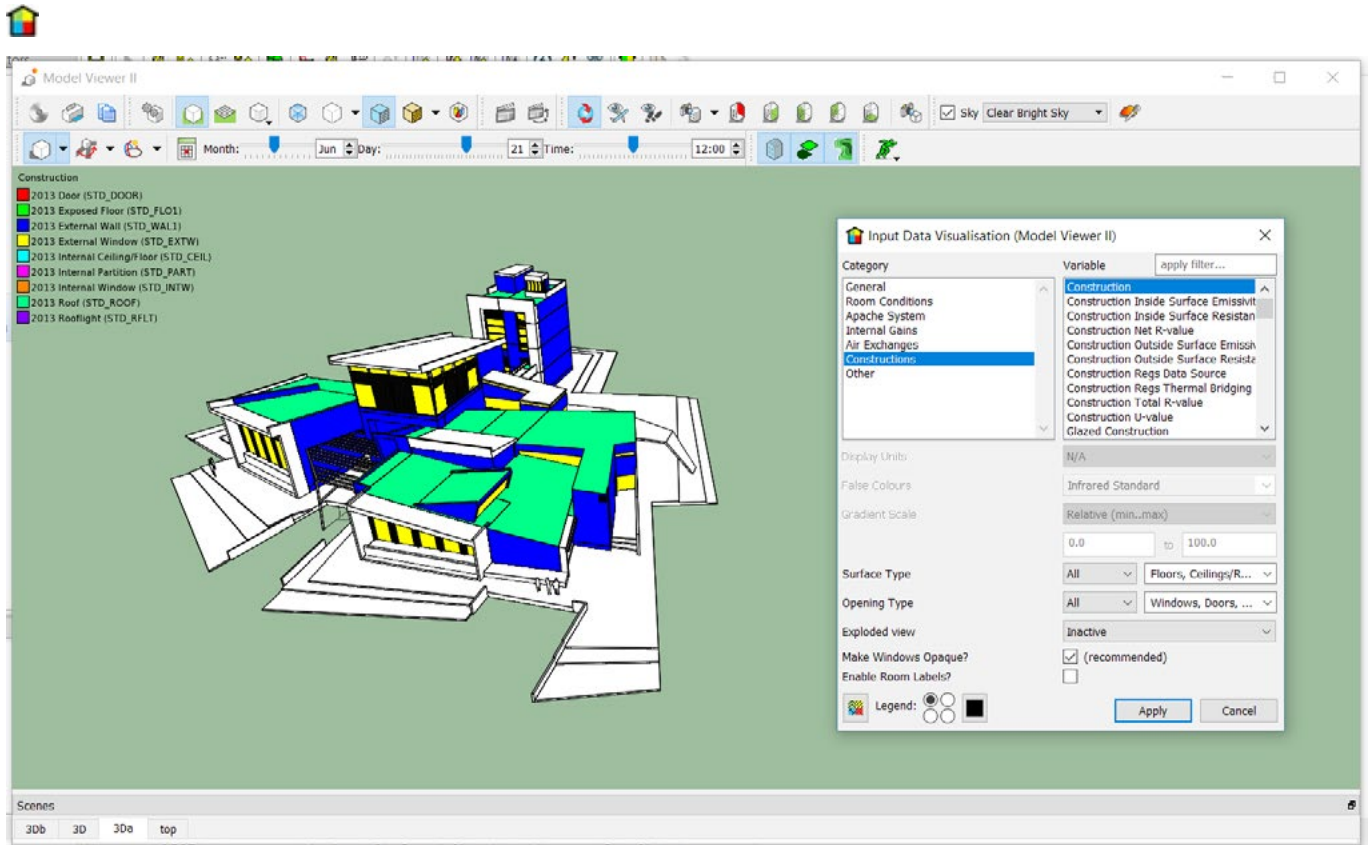

In order to facilitate quality control and checking, data assigned to your model, this can be visualised as colours applied to the model.

You can view an assortment of variables from Apache Systems to Thermal Templates to Internal Gains and much more.

The feature is accessed through the  button on the Apache toolbar.

Note: *Colouring only applies to selected spaces and if the data is available for those spaces. Any spaces not selected or without the specified data will show as white.*

To use the feature you must first select at least one space. The button will then be enabled and upon pressing it, you will be presented with the dialog box. Once you have selected the variables you wish to view, and clicked **Apply**, Model Viewer will launch, showing your selection. The viewing window can be moved, and the selection changed without closing the view.

The **Exploded View** option allows you to explode the model to view each floor and internal space. View options include: Inactive / by storey.

Find out more at https://help.iesve.com/ve2019/input_data_visualisation_1.htm